

Circe

Hinckley Pilot 35 sloop

Designer: Sparkman & Stephens Builder: Hinckley Co. Year: 1966

Over the course of last sailing season, Circe visited spruce covered islands, ghosted through breathtaking passages, and kept her visitors snug and comfy as a country inn. Her five-berth layout offers ample storage and her galley is equipped for preparing everything from lobster dinner to blueberry pie.

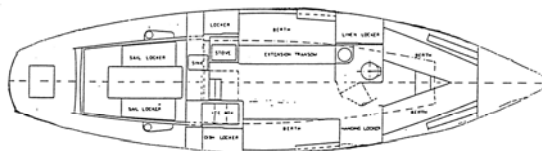

Documentation #: 504907

LOA 35'9"

LWL 25'0"

Beam 9'6"

Draft 5'0"

Tankage:

70 gal water

35 gal fuel

Displacement 13,500 lbs

Engine:

Yanmar 35 hp diesel

Sails:

Main w/full battens & lazy
jacks

135% genoa (2003)

Hull color: Crimson Red
(2005)



ACCOMMODATIONS

Circe has berths for five in two cabins. There is a V-berth forward with filler, and two transom berths and one pilot berth to port in the main salon. The head is equipped with a shower and hot & cold pressurized water. The galley is equipped with an icebox and a Force 10 three-burner propane stove with oven.

ELECTRONICS

Raymarine C-80 Chart Plotter/Radar (2008); Raytheon Nav 300 GPS with WAAS; Raytheon Tridata: speed, depth, and log; Raytheon windmeter (true/apparent); Icom VHF; Jensen AM/FM CD stereo and 12 volt outlet for cellular phone.

ADDITIONAL EQUIPMENT

Hood roller furler for headsail, wheel steering, self-tailing winches, dodger, cockpit cushions and comfortable backrests, teak boarding ladder, screens, charcoal BBQ, and Avon (2008) with a 2½ h.p. four-stroke Yamaha outboard.

COMPLETE WITH

Linen (two sheets, one pillow case, two towels and a face cloth for each member of your party plus a dish towel and potholder), operating instructions, charts (complete Maine Coast), boating almanac, tide table, cruising guide, basic safety equipment, eating & cooking utensils, blankets & pillows, basic mechanical & navigational tools, fuel, water, and ice.

YOU BRING

Binoculars, foul weather gear (with hopes that you won't need it), warm clothes for sailing, t-shirts and shorts for sitting at anchor and exploring islands.

HINCKLEY YACHT CHARTERS

At Great Harbor Marina, Southwest Harbor, Maine 04679

1-800-HYC-SAIL or 207-244-5008 within Maine & outside USA; FAX 207-244-7535

e-mail – charters@hinckleyyachts.com website - www.hinckleycharters.com

